

ELEVATION CERTIFICATE

IMPORTANT: Follow the instructions on pages 1-9.

OMB No. 1660-0008
 Expiration Date: July 31, 2015

SECTION A - PROPERTY INFORMATION

FOR INSURANCE COMPANY USE

A1. Building Owner's Name Jerry Paulk	Policy Number:
A2. Building Street Address (including Apt., Unit, Suite, and/or Bldg. No.) or P.O. Route and Box No. 22914 Ann Miller Road	Company NAIC Number:
City Panama City Beach	State FL
ZIP Code 32413	
A3. Property Description (Lot and Block Numbers, Tax Parcel Number, Legal Description, etc.) Por. Government Lot 31, Sec. 32, T2S, R17W; Bay County Parcel No. 35249-020-000	
A4. Building Use (e.g., Residential, Non-Residential, Addition, Accessory, etc.) Residential	
A5. Latitude/Longitude: Lat. 30 16 05 1 Long. 85 58 21 9 Horizontal Datum: <input type="checkbox"/> NAD 1927 <input checked="" type="checkbox"/> NAD 1983	
A6. Attach at least 2 photographs of the building if the Certificate is being used to obtain flood insurance.	
A7. Building Diagram Number 1B	
A8. For a building with a crawlspace or enclosure(s):	A9. For a building with an attached garage:
a) Square footage of crawlspace or enclosure(s) 0 sq ft	a) Square footage of attached garage 0 sq ft
b) No. of permanent flood openings in the crawlspace or enclosure(s) within 1.0 foot above adjacent grade 0	b) Number of permanent flood openings in the attached garage within 1.0 foot above adjacent grade 0
c) Total net area of flood openings in A8.b 0 sq in	c) Total net area of flood openings in A9.b 0 sq in
d) Engineered flood openings? <input type="checkbox"/> Yes <input checked="" type="checkbox"/> No	d) Engineered flood openings? <input type="checkbox"/> Yes <input checked="" type="checkbox"/> No

SECTION B - FLOOD INSURANCE RATE MAP (FIRM) INFORMATION

B1. NFIP Community Name & Community Number Bay County 1200004			B2. County Name Bay			B3. State FL		
B4. Map/Panel Number 12005C0163	B5. Suffix H	B6. FIRM Index Date 06/02/2009	B7. FIRM Panel Effective/ Revised Date 06/02/2009	B8. Flood Zone(s) AE	B9. Base Flood Elevation(s) (Zone AO, use base flood depth) 8			

B10. Indicate the source of the Base Flood Elevation (BFE) data or base flood depth entered in Item B9:
 FIS Profile FIRM Community Determined Other/Source: _____

B11. Indicate elevation datum used for BFE in Item B9: NGVD 1929 NAVD 1988 Other/Source: _____

B12. Is the building located in a Coastal Barrier Resources System (CBRS) area or Otherwise Protected Area (OPA)? Yes No
 Designation Date: _____ / _____ / _____ CBRS OPA

SECTION C - BUILDING ELEVATION INFORMATION (SURVEY REQUIRED)

C1. Building elevations are based on: Construction Drawings* Building Under Construction* Finished Construction
 *A new Elevation Certificate will be required when construction of the building is complete.

C2. Elevations - Zones A1-A30, AE, AH, A (with BFE), VE, V1-V30, V (with BFE), AR, AR/A, AR/AE, AR/A1-A30, AR/AH, AR/AO. Complete Items C2.a-h below according to the building diagram specified in Item A7. In Puerto Rico only, enter meters.
 Benchmark Utilized: **NGS Q 177** Vertical Datum: **NAVD 88**

Indicate elevation datum used for the elevations in items a) through h) below. NGVD 1929 NAVD 1988 Other/Source: _____
 Datum used for building elevations must be the same as that used for the BFE.

Check the measurement used.

a) Top of bottom floor (including basement, crawlspace, or enclosure floor)	9 . 36	<input checked="" type="checkbox"/> feet <input type="checkbox"/> meters
b) Top of the next higher floor	N/A	<input type="checkbox"/> feet <input type="checkbox"/> meters
c) Bottom of the lowest horizontal structural member (V Zones only)	N/A	<input type="checkbox"/> feet <input type="checkbox"/> meters
d) Attached garage (top of slab)	N/A	<input type="checkbox"/> feet <input type="checkbox"/> meters
e) Lowest elevation of machinery or equipment servicing the building (Describe type of equipment and location in Comments)	9 . 71	<input checked="" type="checkbox"/> feet <input type="checkbox"/> meters
f) Lowest adjacent (finished) grade next to building (LAG)	4 . 04	<input checked="" type="checkbox"/> feet <input type="checkbox"/> meters
g) Highest adjacent (finished) grade next to building (HAG)	8 . 01	<input checked="" type="checkbox"/> feet <input type="checkbox"/> meters
h) Lowest adjacent grade at lowest elevation of deck or stairs, including structural support	4 . 04	<input checked="" type="checkbox"/> feet <input type="checkbox"/> meters

SECTION D - SURVEYOR, ENGINEER, OR ARCHITECT CERTIFICATION

This certification is to be signed and sealed by a land surveyor, engineer, or architect authorized by law to certify elevation information. I certify that the information on this Certificate represents my best efforts to interpret the data available. I understand that any false statement may be punishable by fine or imprisonment under 18 U.S. Code, Section 1001.

- Check here if comments are provided on back of form. Were latitude and longitude in Section A provided by a licensed land surveyor? Yes No
- Check here if attachments.

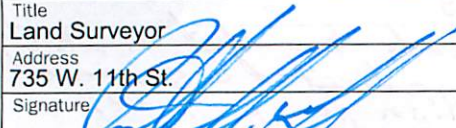
Certifier's Name Jonathan H. Gibson		License Number 6851	
Title Land Surveyor	Company Name Buchanan & Harper, Inc.		
Address 735 W. 11th St.	City Panama City	State FL	ZIP Code 32401
Signature 	Date 07/28/2015	Telephone (850) 763-7427	



ELEVATION CERTIFICATE, page 2

IMPORTANT: In these spaces, copy the corresponding information from Section A.			FOR INSURANCE COMPANY USE	
Building Street Address (including Apt., Unit, Suite, and/or Bldg. No.) or P.O. Route and Box No. 22914 Ann Miller Road			Policy Number:	
City Panama City Beach	State FL	ZIP Code 32413	Company NAIC Number:	

SECTION D – SURVEYOR, ENGINEER, OR ARCHITECT CERTIFICATION (CONTINUED)

Copy both sides of this Elevation Certificate for (1) community official, (2) insurance agent/company, and (3) building owner.

Comments Item C2e is the elevation of an air conditioner pad located adjacent to the residence.

Revised 7-28-15 (AC Pad Adjustment) B&H Job No. 10757; FB 1049, PA. 44

Signature *[Signature]* Date 07/28/2015

SECTION E – BUILDING ELEVATION INFORMATION (SURVEY NOT REQUIRED) FOR ZONE AO AND ZONE A (WITHOUT BFE)

For Zones AO and A (without BFE), complete Items E1–E5. If the Certificate is intended to support a LOMA or LOMR-F request, complete Sections A, B, and C. For Items E1–E4, use natural grade, if available. Check the measurement used. In Puerto Rico only, enter meters.

- E1. Provide elevation information for the following and check the appropriate boxes to show whether the elevation is above or below the highest adjacent grade (HAG) and the lowest adjacent grade (LAG).
 - a) Top of bottom floor (including basement, crawlspace, or enclosure) is _____ . _____ feet meters above or below the HAG.
 - b) Top of bottom floor (including basement, crawlspace, or enclosure) is _____ . _____ feet meters above or below the LAG.
- E2. For Building Diagrams 6–9 with permanent flood openings provided in Section A Items 8 and/or 9 (see pages 8–9 of Instructions), the next higher floor (elevation C2.b in the diagrams) of the building is _____ . _____ feet meters above or below the HAG.
- E3. Attached garage (top of slab) is _____ . _____ feet meters above or below the HAG.
- E4. Top of platform of machinery and/or equipment servicing the building is _____ . _____ feet meters above or below the HAG.
- E5. Zone AO only: If no flood depth number is available, is the top of the bottom floor elevated in accordance with the community's floodplain management ordinance? Yes No Unknown. The local official must certify this information in Section G.

SECTION F – PROPERTY OWNER (OR OWNER'S REPRESENTATIVE) CERTIFICATION

The property owner or owner's authorized representative who completes Sections A, B, and E for Zone A (without a FEMA-issued or community-issued BFE) or Zone AO must sign here. The statements in Sections A, B, and E are correct to the best of my knowledge.

Property Owner or Owner's Authorized Representative's Name _____

Address _____	City _____	State _____	ZIP Code _____
Signature _____	Date _____	Telephone _____	

Comments _____ Check here if attachments.

SECTION G – COMMUNITY INFORMATION (OPTIONAL)

The local official who is authorized by law or ordinance to administer the community's floodplain management ordinance can complete Sections A, B, C (or E), and G of this Elevation Certificate. Complete the applicable item(s) and sign below. Check the measurement used in Items G8–G10. In Puerto Rico only, enter meters.

- G1. The information in Section C was taken from other documentation that has been signed and sealed by a licensed surveyor, engineer, or architect who is authorized by law to certify elevation information. (Indicate the source and date of the elevation data in the Comments area below.)
- G2. A community official completed Section E for a building located in Zone A (without a FEMA-issued or community-issued BFE) or Zone AO.
- G3. The following information (Items G4–G9) is provided for community floodplain management purposes.

G4. Permit Number <i>RBI4-0892</i>	G5. Date Permit Issued <i>11-6-14</i>	G6. Date Certificate of Compliance/Occupancy Issued <i>8-19-15</i>
G7. This permit has been issued for: <input checked="" type="checkbox"/> New Construction <input type="checkbox"/> Substantial Improvement		
G8. Elevation of as-built lowest floor (including basement) of the building: _____ . _____ <input type="checkbox"/> feet <input type="checkbox"/> meters Datum _____		
G9. BFE or (in Zone AO) depth of flooding at the building site: _____ . _____ <input type="checkbox"/> feet <input type="checkbox"/> meters Datum _____		
G10. Community's design flood elevation: _____ . _____ <input type="checkbox"/> feet <input type="checkbox"/> meters Datum _____		

Local Official's Name _____	Title _____
Community Name _____	Telephone _____
Signature _____	Date <i>7-28-15</i>

Comments *D.S. Plans indicate a slab on grade foundation which is diagram 1.B. However, plans indicated a screened porch which is on a pier foundation per picture. Approved since it is not enclosed at this time.* Check here if attachments.

Building Photographs

See Instructions for Item A6.

Building Street Address (including Apt., Unit, Suite, and/or Bldg. No.) or P.O. Route and Box No. 22914 Ann Miller Road	Policy Number
City Panama City Beach State FL Zip Code 32413	Company NAIC Number

If using the Elevation Certificate to obtain NFIP flood insurance, affix at least two building photographs below according to the instructions for Item A6. Identify all photographs with: date taken; "Front View" and "Rear View"; and, if required, "Right Side View" and "Left Side View." If submitting more photographs than will fit on this page, use the Continuation Page, following.

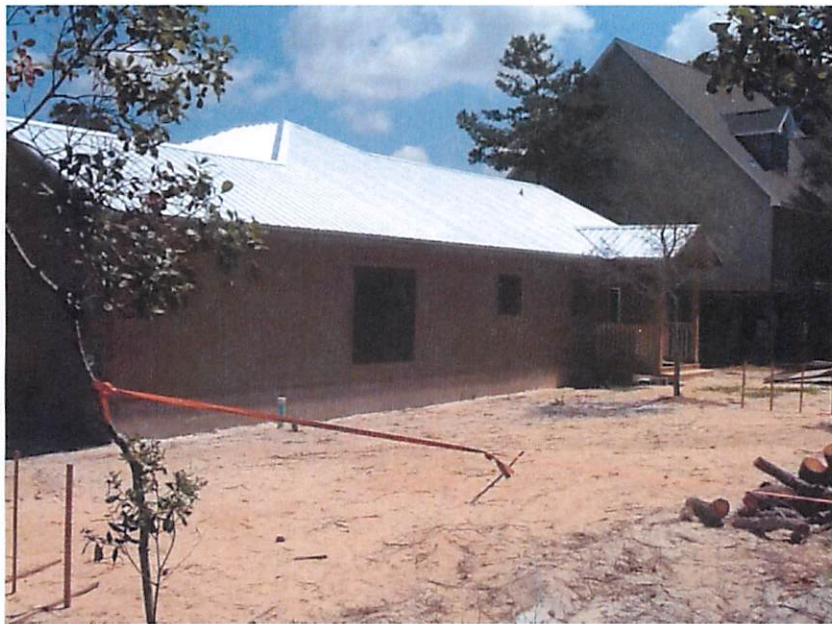

FRONT VIEW (07-20-15)



REAR VIEW (07-20-15)