

ELEVATION CERTIFICATE

Important: Follow the instructions on pages 1-9.

Copy all pages of this Elevation Certificate and all attachments for (1) community official, (2) insurance agent/company, and (3) building owner.

| SECTION A – PROPERTY INFORMATION | | | | FOR INSURANCE COMPANY USE | |
|---|-----------------|-----------------------------------|--|-----------------------------|--|
| A1. Building Owner's Name Southern Coastal Homes, Inc. | | | | Policy Number: | |
| A2. Building Street Address (including Apt., Unit, Suite, and/or Bldg. No.) or P.O. Route and Box No. 434 Locksley Drive | | | | Company NAIC Number: | |
| City Panama City Beach | | State Florida | | ZIP Code 32407 | |
| A3. Property Description (Lot and Block Numbers, Tax Parcel Number, Legal Description, etc.) Lot 22, Breakfast Point Phase 4A | | | | | |
| A4. Building Use (e.g., Residential, Non-Residential, Addition, Accessory, etc.) <u>Residential</u> | | | | | |
| A5. Latitude/Longitude: Lat. <u>30 12' 00.2"</u> Long. <u>85 47' 59.5"</u> Horizontal Datum: <input type="checkbox"/> NAD 1927 <input checked="" type="checkbox"/> NAD 1983 | | | | | |
| A6. Attach at least 2 photographs of the building if the Certificate is being used to obtain flood insurance. | | | | | |
| A7. Building Diagram Number <u>1B</u> | | | | | |
| A8. For a building with a crawlspace or enclosure(s): | | | | | |
| a) Square footage of crawlspace or enclosure(s) <u>0.00</u> sq ft | | | | | |
| b) Number of permanent flood openings in the crawlspace or enclosure(s) within 1.0 foot above adjacent grade <u>0</u> | | | | | |
| c) Total net area of flood openings in A8.b <u>0.00</u> sq in | | | | | |
| d) Engineered flood openings? <input type="checkbox"/> Yes <input checked="" type="checkbox"/> No | | | | | |
| A9. For a building with an attached garage: | | | | | |
| a) Square footage of attached garage <u>393.45</u> sq ft | | | | | |
| b) Number of permanent flood openings in the attached garage within 1.0 foot above adjacent grade <u>0</u> | | | | | |
| c) Total net area of flood openings in A9.b <u>0.00</u> sq in | | | | | |
| d) Engineered flood openings? <input type="checkbox"/> Yes <input checked="" type="checkbox"/> No | | | | | |
| SECTION B – FLOOD INSURANCE RATE MAP (FIRM) INFORMATION | | | | | |
| B1. NFIP Community Name & Community Number Bay County Unincorporated Areas 120004 | | | B2. County Name Bay | | B3. State Florida |
| B4. Map/Panel Number 12005C0308 | B5. Suffix H | B6. FIRM Index Date 06-02-2009 | B7. FIRM Panel Effective/ Revised Date 06-02-2009 | B8. Flood Zone(s) AE & A | B9. Base Flood Elevation(s) (Zone AO, use Base Flood Depth) 9.0 & 9.8 |
| B10. Indicate the source of the Base Flood Elevation (BFE) data or base flood depth entered in Item B9: <input type="checkbox"/> FIS Profile <input type="checkbox"/> FIRM <input checked="" type="checkbox"/> Community Determined <input type="checkbox"/> Other/Source: _____ | | | | | |
| B11. Indicate elevation datum used for BFE in Item B9: <input type="checkbox"/> NGVD 1929 <input checked="" type="checkbox"/> NAVD 1988 <input type="checkbox"/> Other/Source: _____ | | | | | |
| B12. Is the building located in a Coastal Barrier Resources System (CBRS) area or Otherwise Protected Area (OPA)? <input type="checkbox"/> Yes <input checked="" type="checkbox"/> No Designation Date: _____ <input type="checkbox"/> CBRS <input type="checkbox"/> OPA | | | | | |

ELEVATION CERTIFICATE

OMB No. 1660-0008
Expiration Date: November 30, 2022

| | | | | |
|---|------------------|-------------------|----------------------------------|--|
| IMPORTANT: In these spaces, copy the corresponding information from Section A. | | | FOR INSURANCE COMPANY USE | |
| Building Street Address (including Apt., Unit, Suite, and/or Bldg. No.) or P.O. Route and Box No. 434 Locksley Drive | | | Policy Number: | |
| City Panama City Beach | State Florida | ZIP Code 32407 | Company NAIC Number | |

SECTION C – BUILDING ELEVATION INFORMATION (SURVEY REQUIRED)

C1. Building elevations are based on: Construction Drawings* Building Under Construction* Finished Construction

*A new Elevation Certificate will be required when construction of the building is complete.

C2. Elevations – Zones A1–A30, AE, AH, A (with BFE), VE, V1–V30, V (with BFE), AR, AR/A, AR/AE, AR/A1–A30, AR/AH, AR/AO. Complete Items C2.a–h below according to the building diagram specified in Item A7. In Puerto Rico only, enter meters.

Benchmark Utilized: NGS X 182 Vertical Datum: NAVD 88

Indicate elevation datum used for the elevations in items a) through h) below.

NGVD 1929 NAVD 1988 Other/Source: _____

Datum used for building elevations must be the same as that used for the BFE.

Check the measurement used.

- | | | | |
|---|-------------|--|---------------------------------|
| a) Top of bottom floor (including basement, crawlspace, or enclosure floor) | <u>15.8</u> | <input checked="" type="checkbox"/> feet | <input type="checkbox"/> meters |
| b) Top of the next higher floor | <u>N/A</u> | <input type="checkbox"/> feet | <input type="checkbox"/> meters |
| c) Bottom of the lowest horizontal structural member (V Zones only) | <u>N/A</u> | <input type="checkbox"/> feet | <input type="checkbox"/> meters |
| d) Attached garage (top of slab) | <u>15.3</u> | <input checked="" type="checkbox"/> feet | <input type="checkbox"/> meters |
| e) Lowest elevation of machinery or equipment servicing the building (Describe type of equipment and location in Comments) | <u>15.5</u> | <input checked="" type="checkbox"/> feet | <input type="checkbox"/> meters |
| f) Lowest adjacent (finished) grade next to building (LAG) | <u>14.8</u> | <input checked="" type="checkbox"/> feet | <input type="checkbox"/> meters |
| g) Highest adjacent (finished) grade next to building (HAG) | <u>15.3</u> | <input checked="" type="checkbox"/> feet | <input type="checkbox"/> meters |
| h) Lowest adjacent grade at lowest elevation of deck or stairs, including structural support | <u>N/A</u> | <input type="checkbox"/> feet | <input type="checkbox"/> meters |

SECTION D – SURVEYOR, ENGINEER, OR ARCHITECT CERTIFICATION

This certification is to be signed and sealed by a land surveyor, engineer, or architect authorized by law to certify elevation information. I certify that the information on this Certificate represents my best efforts to interpret the data available. I understand that any false statement may be punishable by fine or imprisonment under 18 U.S. Code, Section 1001.

Were latitude and longitude in Section A provided by a licensed land surveyor? Yes No Check here if attachments.

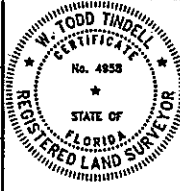
| | | | |
|---|------------------------|---|-------------------|
| Certifier's Name W. Todd Tindell | License Number 4958 |  | |
| Title Land Surveyor | | | |
| Company Name Buchanan & Harper, Inc. | | | |
| Address 735 W. 11th Street | | | |
| City Panama City | State Florida | | ZIP Code 32401 |
| Signature <i>W. Tindell</i> | Date 03-25-2022 | Telephone (850) 763-7427 | Ext. |

Copy all pages of this Elevation Certificate and all attachments for (1) community official, (2) insurance agent/company, and (3) building owner.

Comments (including type of equipment and location, per C2(e), if applicable)

C2e is the top elevation of an HVAC pad.

THE SEAL APPEARING ON THIS DOCUMENT WAS AUTHORIZED BY W. TODD TINDELL PSM NO. 4958 ON DATE OF DIGITAL SIGNATURE

ELEVATION CERTIFICATE

OMB No. 1660-0008
Expiration Date: November 30, 2022

| | | | |
|---|------------------|-------------------|----------------------------------|
| IMPORTANT: In these spaces, copy the corresponding information from Section A. | | | FOR INSURANCE COMPANY USE |
| Building Street Address (including Apt., Unit, Suite, and/or Bldg. No.) or P.O. Route and Box No. 434 Locksley Drive | | | Policy Number: |
| City Panama City Beach | State Florida | ZIP Code 32407 | Company NAIC Number |

**SECTION E – BUILDING ELEVATION INFORMATION (SURVEY NOT REQUIRED)
FOR ZONE AO AND ZONE A (WITHOUT BFE)**

For Zones AO and A (without BFE), complete Items E1–E5. If the Certificate is intended to support a LOMA or LOMR-F request, complete Sections A, B, and C. For Items E1–E4, use natural grade, if available. Check the measurement used. In Puerto Rico only, enter meters.

- E1. Provide elevation information for the following and check the appropriate boxes to show whether the elevation is above or below the highest adjacent grade (HAG) and the lowest adjacent grade (LAG).
- a) Top of bottom floor (including basement, crawlspace, or enclosure) is _____ feet meters above or below the HAG.
- b) Top of bottom floor (including basement, crawlspace, or enclosure) is _____ feet meters above or below the LAG.
- E2. For Building Diagrams 6–9 with permanent flood openings provided in Section A Items 8 and/or 9 (see pages 1–2 of Instructions), the next higher floor (elevation C2.b in the diagrams) of the building is _____ feet meters above or below the HAG.
- E3. Attached garage (top of slab) is _____ feet meters above or below the HAG.
- E4. Top of platform of machinery and/or equipment servicing the building is _____ feet meters above or below the HAG.
- E5. Zone AO only: If no flood depth number is available, is the top of the bottom floor elevated in accordance with the community's floodplain management ordinance? Yes No Unknown. The local official must certify this information in Section G.

SECTION F – PROPERTY OWNER (OR OWNER'S REPRESENTATIVE) CERTIFICATION

The property owner or owner's authorized representative who completes Sections A, B, and E for Zone A (without a FEMA-issued or community-issued BFE) or Zone AO must sign here. The statements in Sections A, B, and E are correct to the best of my knowledge.

Property Owner or Owner's Authorized Representative's Name

Address _____ City _____ State _____ ZIP Code _____

Signature _____ Date _____ Telephone _____

Comments

Check here if attachments.

ELEVATION CERTIFICATE

OMB No. 1660-0008
Expiration Date: November 30, 2022

| | | | |
|---|------------------|-------------------|----------------------------------|
| IMPORTANT: In these spaces, copy the corresponding information from Section A. | | | FOR INSURANCE COMPANY USE |
| Building Street Address (including Apt., Unit, Suite, and/or Bldg. No.) or P.O. Route and Box No. 434 Locksley Drive | | | Policy Number: |
| City Panama City Beach | State Florida | ZIP Code 32407 | Company NAIC Number |

SECTION G – COMMUNITY INFORMATION (OPTIONAL)

The local official who is authorized by law or ordinance to administer the community's floodplain management ordinance can complete Sections A, B, C (or E), and G of this Elevation Certificate. Complete the applicable item(s) and sign below. Check the measurement used in Items G8–G10. In Puerto Rico only, enter meters.

- G1. The information in Section C was taken from other documentation that has been signed and sealed by a licensed surveyor, engineer, or architect who is authorized by law to certify elevation information. (Indicate the source and date of the elevation data in the Comments area below.)
- G2. A community official completed Section E for a building located in Zone A (without a FEMA-issued or community-issued BFE) or Zone AO.
- G3. The following information (Items G4–G10) is provided for community floodplain management purposes.

| | | |
|--|--|---|
| G4. Permit Number <i>RB21-01473</i> | G5. Date Permit Issued <i>8/24/2021</i> | G6. Date Certificate of Compliance/Occupancy Issued |
|--|--|---|

- G7. This permit has been issued for: New Construction Substantial Improvement
- G8. Elevation of as-built lowest floor (including basement) of the building: _____ feet meters Datum _____
- G9. BFE or (in Zone AO) depth of flooding at the building site: _____ feet meters Datum _____
- G10. Community's design flood elevation: _____ feet meters Datum _____

| | |
|--|--------------------------|
| Local Official's Name <i>Wayne Porter</i> | Title |
| Community Name | Telephone |
| Signature <i>[Signature]</i> | Date <i>5/23/2022</i> |

Comments (including type of equipment and location, per C2(e), if applicable)

ok for co

[Signature]

Check here if attachments.

ELEVATION CERTIFICATE

BUILDING PHOTOGRAPHS

See Instructions for Item A6.

OMB No. 1660-0008
Expiration Date: November 30, 2022

| | | | |
|---|------------------|-------------------|----------------------------------|
| IMPORTANT: In these spaces, copy the corresponding information from Section A. | | | FOR INSURANCE COMPANY USE |
| Building Street Address (including Apt., Unit, Suite, and/or Bldg. No.) or P.O. Route and Box No. 434 Locksley Drive | | | Policy Number: |
| City Panama City Beach | State Florida | ZIP Code 32407 | Company NAIC Number |

If using the Elevation Certificate to obtain NFIP flood insurance, affix at least 2 building photographs below according to the instructions for Item A6. Identify all photographs with date taken; "Front View" and "Rear View"; and, if required, "Right Side View" and "Left Side View." When applicable, photographs must show the foundation with representative examples of the flood openings or vents, as indicated in Section A8. If submitting more photographs than will fit on this page, use the Continuation Page.

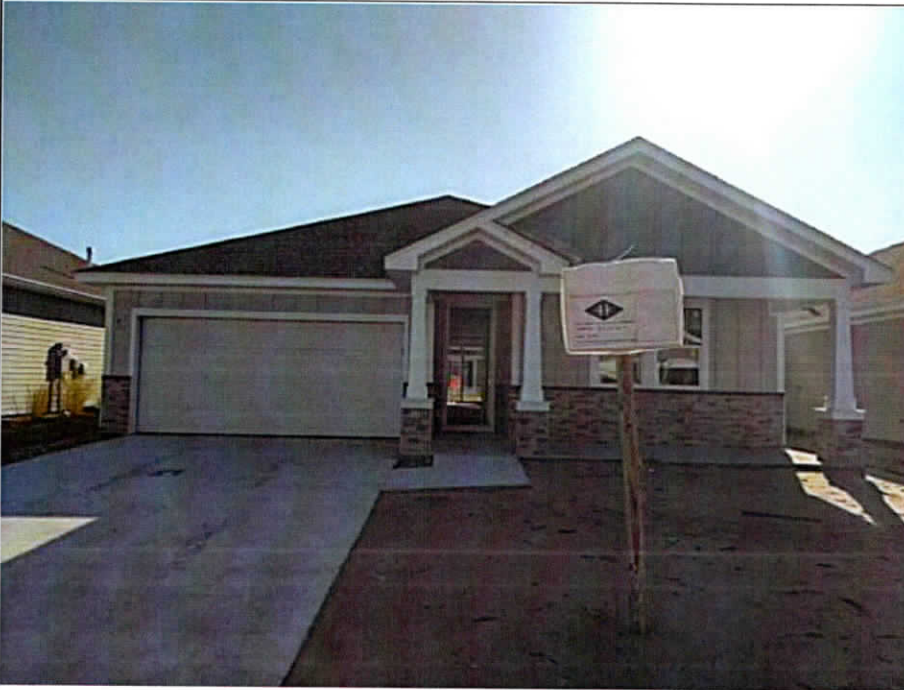

Photo One

Photo One Caption Front View

Clear Photo One



Photo Two

Photo Two Caption Left Side View

Clear Photo Two

ELEVATION CERTIFICATE

BUILDING PHOTOGRAPHS

Continuation Page

OMB No. 1660-0008
Expiration Date: November 30, 2022

| | | | |
|---|------------------|-------------------|----------------------------------|
| IMPORTANT: In these spaces, copy the corresponding information from Section A. | | | FOR INSURANCE COMPANY USE |
| Building Street Address (including Apt., Unit, Suite, and/or Bldg. No.) or P.O. Route and Box No. 434 Locksley Drive | | | Policy Number: |
| City Panama City Beach | State Florida | ZIP Code 32407 | Company NAIC Number |

If submitting more photographs than will fit on the preceding page, affix the additional photographs below. Identify all photographs with: date taken; "Front View" and "Rear View"; and, if required, "Right Side View" and "Left Side View." When applicable, photographs must show the foundation with representative examples of the flood openings or vents, as indicated in Section A8.

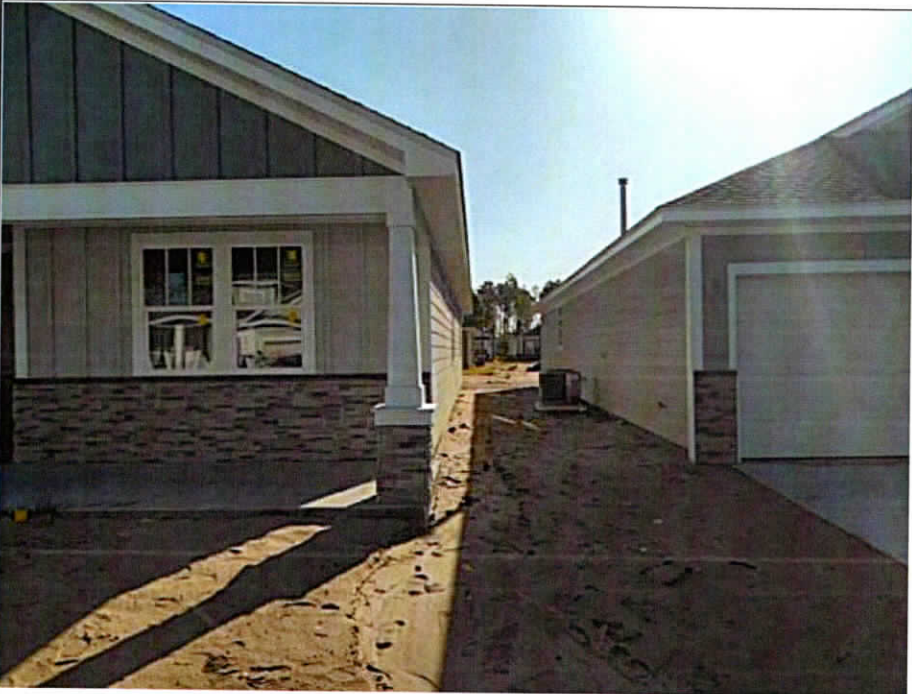

Photo Three

Photo Three Caption Right Side View

Clear Photo Three



Photo Four

Photo Four Caption Rear View

Clear Photo Four