

ZONE V DESIGN CERTIFICATE

Name Augusto Aday Policy Number (Insurance Co. Use) _____
 Building Address or Other Description 2629 Mound Avenue
 Permit No. _____ City Panama City State FL Zip Code 32405

SECTION I: Flood Insurance Rate Map (FIRM) Information

Community Name & No. Bay County Unincorporated Area 120004 Panel No. 12005C0329 Suffix H FIRM Date 06-02-2009
 FIRM Zone(s) AE & VE Seaward of LIMWA (Coastal A Zone) Yes No

SECTION II: Elevation Information Used for Design

[NOTE: This section documents elevations used in the design – it does not substitute for an as-built Elevation Certificate.]

1. Datum..... NGVD NAVD Other
2. Elevation of the Bottom of Lowest Horizontal Structural Member -1.67 feet above datum
3. Base Flood Elevation (BFE)..... 8.0&10.0feet above datum
4. Elevation of Lowest Adjacent Grade 4.0 feet above datum
5. Approximate Depth of Anticipated Scour/Erosion used for Foundation Design..... 0.0 feet
6. Embedment Depth of Pilings or Foundation Below Lowest Adjacent Grade..... 0.0 feet

SECTION III: Zone V Design Certification Statement

[NOTE. This section must be certified by a Florida licensed engineer or architect.]

I certify: (1) I have developed or reviewed the structural design, plans, and specifications for construction and (2) the design and methods of construction to be used are in accordance with accepted standards of practice for meeting the following provisions:

- The bottom of the lowest horizontal structural member of the lowest floor (with the exception of mat or raft foundations, piling, pile caps, columns, grade beams and bracing) is elevated to _____ above the BFE in accordance with the requirements of the *Florida Building Code* or local floodplain management regulations (manufactured homes and buildings exempt from the FBC, B); and
- The pile and column foundation and building or structure to be attached hereto is designed in accordance with the *Florida Building Code* to be anchored to resist flotation, collapse, and lateral movement due to the effects of the wind and flood loads acting simultaneously on all building components, and other load requirements of the *Florida Building Code*. The potential for scour and erosion at the foundation has been anticipated for conditions associated with the base flood, including wave action.

E.P. Consultants, Inc.
 Professional Engineer
 Victor M. Santana III
 License # 1354

SECTION IV: Breakaway Wall Design Certification Statement

[NOTE. This section must also be certified by a Florida licensed engineer or architect when breakaway walls exceed a design safe loading resistance of 20 pounds per square foot. This requirement does not apply to open wood/plastic lattice/slats/louvers or insect screening.]

I certify: (1) I have developed or reviewed the structural design, plans, and specifications for construction and (2) the design and methods of construction to be used for the breakaway walls are in accordance with the *Florida Building Code, Building (ASCE 24)* or *Florida Building Code, Residential*, as applicable, and accepted standards of practice.

SECTION V: Certification and Seal

This certification is to be signed and sealed by a Florida licensed professional engineer or architect authorized by law to certify structural designs. I certify the Zone V Design Certification Statement in Section III and the Breakaway Wall Design Certification Statement in Section IV (if applicable).

Victor Manuel Santana III		CGC1508582	
Certifier's Name	Managing Member	Florida License Number	
10375 SW 68 Lane	VMS Architecture & Development, LLC	Florida	33173
Address	Company Name	State	ZIP
	City	State	ZIP
	10.06.2023	305-834-8736	
Signature	Date	Telephone	



POOLDESIGN.NET
 30 S.W. 5th COURT
 POMPANO BEACH FLA. 33060
 (954) 941-1124
 info@pooldesign.net

CERTIFICATE OF AUTHORIZATION N. 8871
 DESIGN PER FLORIDA BUILDING CODE 061-424
 INCLUDING BUT NOT LIMITED TO
 424.2.8.8 (4) 4.1 ENTIREMENT PROTECTION FOR LIFTING
 SALES

REVISIONS

- GENERAL NOTES
- 1) REFER TO PERMITS 2002 78 SECTION F.B.C. RESIDENTIAL PERMITS AND AMENDMENTS AND PERMITS AND PERMITS 2002 78 SECTION F.B.C. RESIDENTIAL PERMITS AND AMENDMENTS.
 - 2) THE SITE MUST HAVE UNDISTURBED SAND, ROCK, SAND AND ROCK WITH A MINIMUM DRAINAGE VALUE OF 2000 P.S.F.
 - 3) ALL CONCRETE SHALL BE CAST AND CURED IN ACCORDANCE WITH THE CONDITIONS IN THIS AREA HAVE BEEN MET WITH APPROPRIATE CARE AND SUPPORTING A POOL AND DECK OF SIMILAR SIZE AND WEIGHT AS THE POOL AND DECK TO BE CONSTRUCTED ABOVE. THE ENGINEER SHALL BE NOTIFIED PRIOR TO FURTHER CONSTRUCTION OF THIS PROJECT.
 - 4) ALL CONCRETE SHALL CONFORM TO ACI 318-14. CONCRETE SHALL HAVE A MINIMUM COMPRESSIVE STRENGTH OF 3000 PSI FOR FINISHES AND 4000 PSI FOR FINISHES WITH REINFORCEMENT.
 - 5) REINFORCING STEEL SHALL BE ASTM DESIGNATION #63 GRADE WITH A MINIMUM YIELDING STRENGTH OF 60,000 PSI. ALL REINFORCING SHALL BE MADE IN THE USA AND SHALL BE PLACED AND PLACEMENT SHALL CONFORM TO ACI 318-14.
 - 6) ALL POOL PAVING SHALL BEAR THE FULL LOAD OF THE POOL AND EQUIPMENT WITH A MINIMUM YIELDING STRENGTH OF 3000 PSI TO CONFORM WITH F.B.C. POOL EQUIPMENT TO APPLY TO F.B.C.
 - 7) WATER SUPPLY AND DISPOSAL SHALL BE SO ARRANGED THAT THERE IS NO CROSS CONNECTION WITH A DOMESTIC WATER SUPPLY. THE DISPOSAL SYSTEM SHALL MEET ALL REQUIREMENTS IN F.B.C.
 - 8) EQUIPMENT SCHEDULING GRID SHALL BE INSTALLED PER 2017 NEC SECTION 480.2(B)(3).

Digitally signed by
Bradley M. Akers
 Date: **2023.03.30 11:42:29 -04'00'**

B. M. AKERS
 P.E. 68448

POOL AREA PLAN

TITLE
ADAY RESIDENCE

DESCRIPTION
 2829 MOUND AVENUE
 PANAMA CITY, FL 32405

DATE
 3/30/2023

PAGE
 1 OF 4

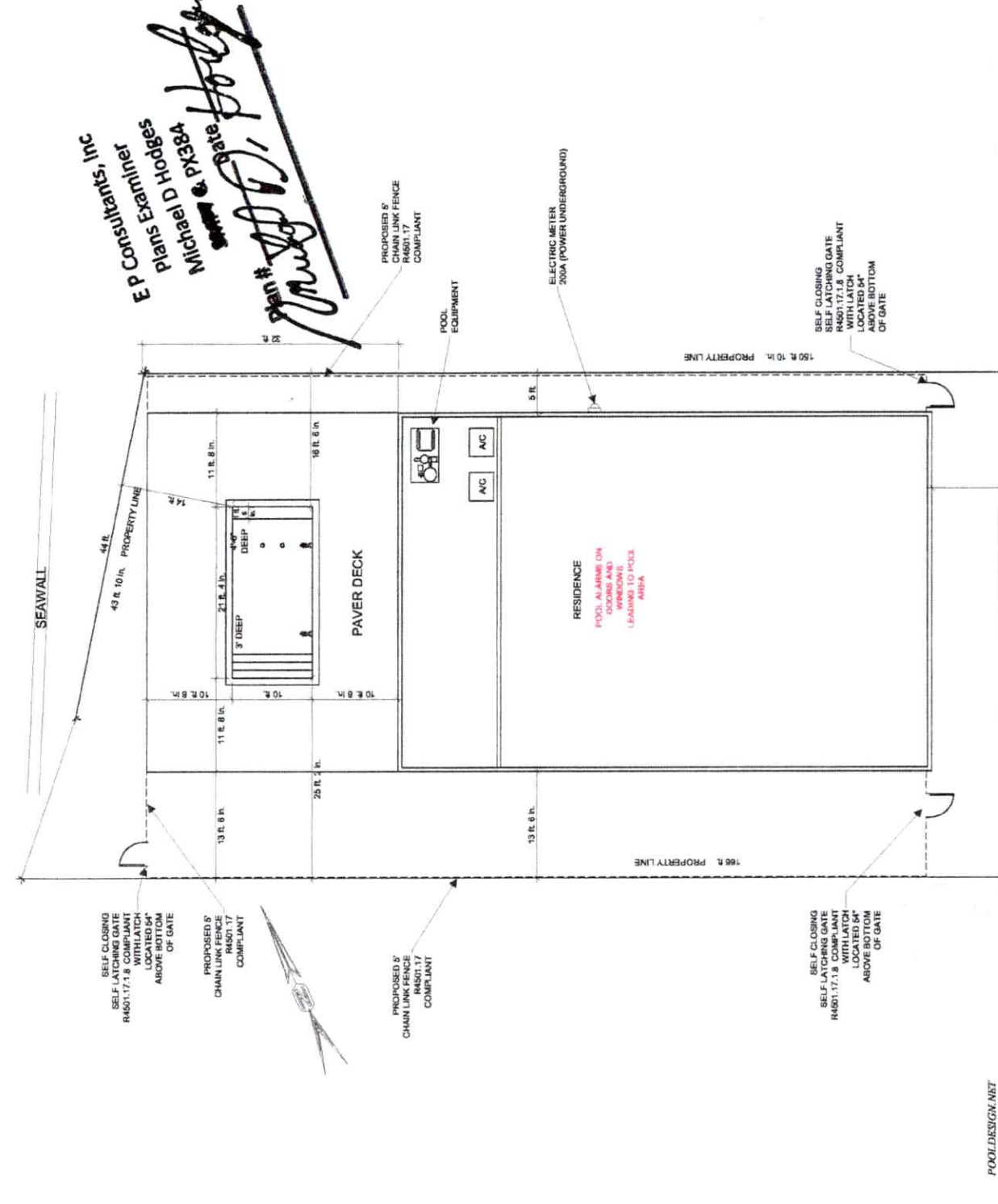

E Consultants, Inc
 Plans Examiner
Michael D Hodges
 License # **PX384**
 State of **Florida**

POOLDESIGN.NET
 30 S.W. 6th COURT
 POMPANO BEACH FLA 33060
 (954) 941-1124
 info@poolsdesign.net
 CERTIFICATE OF AUTHORIZATION N
 9871

REVISIONS

GENERAL NOTE
 THIS DRAWING IS TO BE USED IN CONJUNCTION WITH THE APPROVED PERMITS AND ALL NECESSARY REGULATIONS, ORDINANCES, AND SPECIFICATIONS OF THE DEPARTMENT OF PUBLIC WORKS, COUNTY OF DADE, FLORIDA.

1. THE POOL SHALL BE CONSTRUCTED WITH A MINIMUM FINISH VALUE OF 300 PSI.
 2. THE FOLLOWING IS RETAINED BY THE OWNER. ANY CHANGES TO THE PLAN SHALL BE MADE IN WRITING BY THE ARCHITECT OR ENGINEER. ANY CHANGES MADE WITHOUT THE WRITING OF THE ARCHITECT OR ENGINEER SHALL BE AT THE OWNER'S RISK.
 3. ALL CONCRETE SHALL CONFORM TO 3181 S.F. FOR ALL CONCRETE. ALL CONCRETE SHALL HAVE A MINIMUM COMPRESSIVE STRENGTH OF 3000 PSI FOR PRECAST/PRECAST CONCRETE STRUCTURES.
 4. REINFORCING STEEL SHALL BE ASTM REBAR/STEEL AS ALL. REINFORCING SHALL BE PROTECTED BY A MINIMUM OF 2" FROM ALL FRESH CONCRETE. ALL REBAR SHALL BE PLACED TO BE PROTECTED BY A MINIMUM OF 2" FROM ALL FRESH CONCRETE.
 5. FINISH ALL POOL FLOOR SHALL BEAR THE 1/4" PER FOOT SLOPE TO DRAINAGE. ALL POOL FLOOR SHALL BE FINISHED TO DRAIN TO THE MAIN DRAIN. ALL POOL FLOOR SHALL BE FINISHED TO DRAIN TO THE MAIN DRAIN.
 6. THERE IS NO COVER CONNECTION WITH A COVERED MAIN DRAIN. ALL POOL FLOOR SHALL BE FINISHED TO DRAIN TO THE MAIN DRAIN.
 7. ALL POOL FLOOR SHALL BE FINISHED TO DRAIN TO THE MAIN DRAIN.
 8. ALL POOL FLOOR SHALL BE FINISHED TO DRAIN TO THE MAIN DRAIN.
 9. ALL POOL FLOOR SHALL BE FINISHED TO DRAIN TO THE MAIN DRAIN.
 10. ALL POOL FLOOR SHALL BE FINISHED TO DRAIN TO THE MAIN DRAIN.
 11. ALL POOL FLOOR SHALL BE FINISHED TO DRAIN TO THE MAIN DRAIN.
 12. ALL POOL FLOOR SHALL BE FINISHED TO DRAIN TO THE MAIN DRAIN.

Digitally signed by
 Bradley M. Akers

Date: 2023.03.30
 11:42:50
 -04'00'

B. M. AKERS
 P.E. 89448

LAYOUT PLAN

ADAY RESIDENCE
 EQUIPMENT ROOM AND AVENUE
 PANAMA CITY, FL 32305.

DATE 3/30/2023
 PAGE 2 OF 4

448 PROPERTY
 E.P. Consultants, Inc
 Plans Examiner
 Michael D Hodges
 11238994 PX384

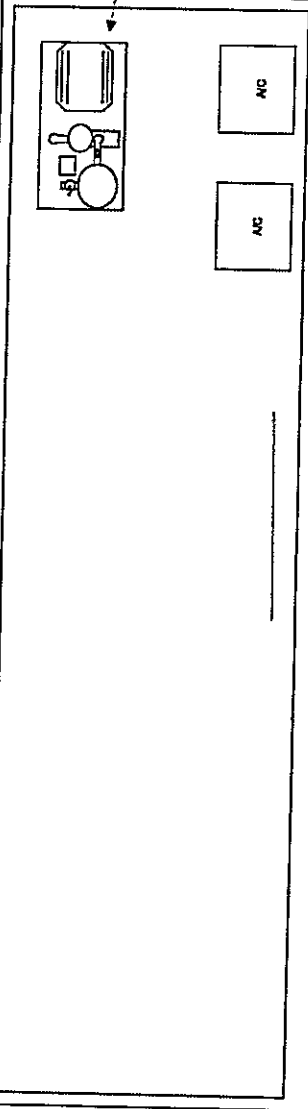
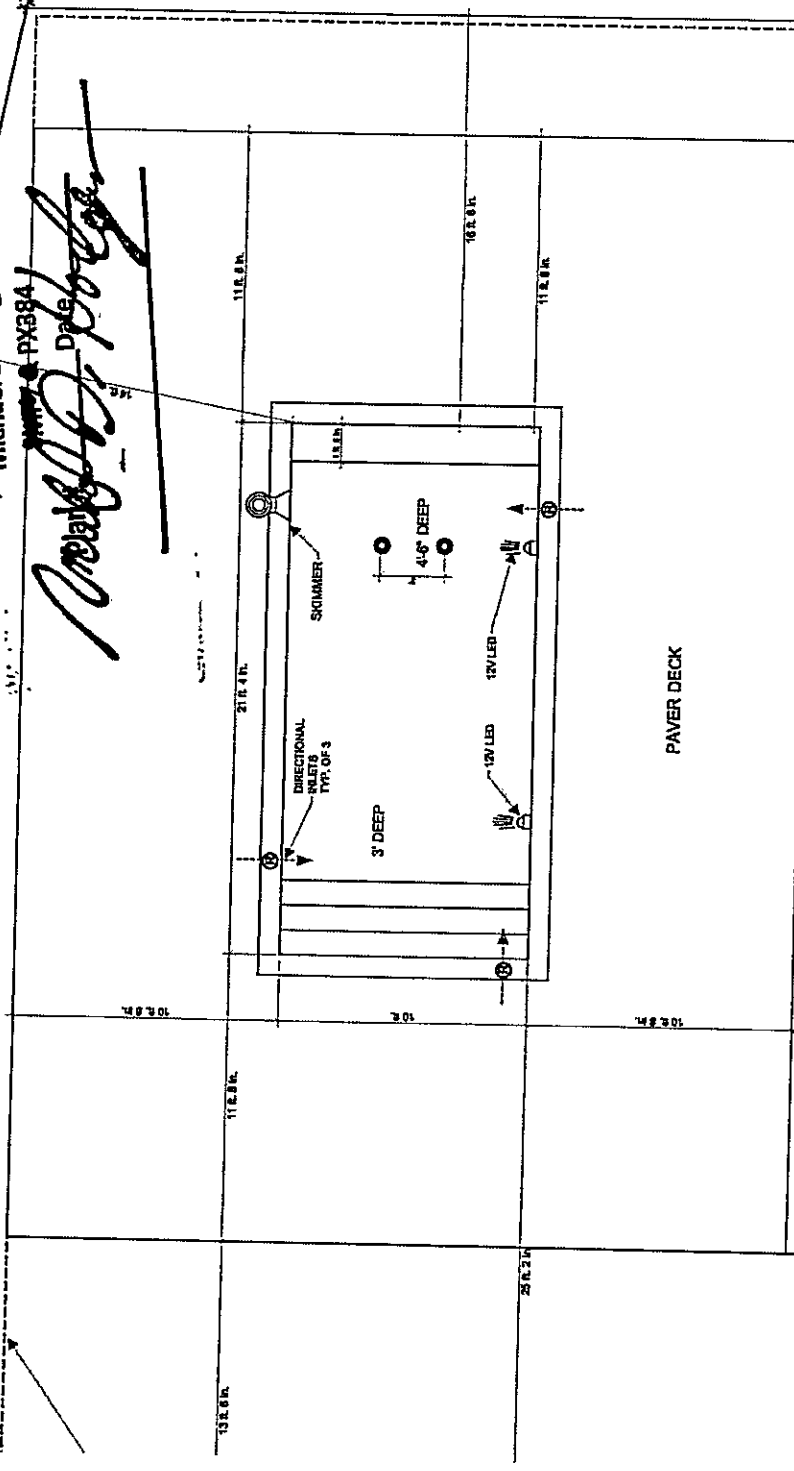
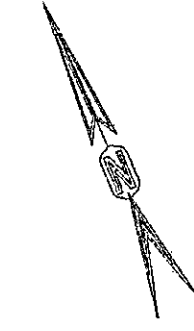
POOLDESIGN.NET
 30 S.W. 5th COURT
 POMPANO BEACH FLA. 33060
 (954) 941-1124
 info@awmimpoolplan.com
 CERTIFICATE OF AUTHORIZATION N.
 9971

DESIGN PER FLORIDA BUILDING CODE 648.3
 INCLUDING BUT NOT LIMITED TO
 648.3.8 (PARTIAL) ENTRAPMENT PROTECTION FOR SUCTION
 HEADS
 648.3.7 RESIDENTIAL SWIMMING BARRIER REQUIREMENTS

REVISIONS

GENERAL NOTES:

- 1) ALL WORK SHALL BE IN ACCORDANCE WITH THE 2017 EDITION F.L.C. RESIDENTIAL CHAPTER 648 AND ANY AMENDMENTS, ORDINANCES, AND LOCAL LAWS.
- 2) THE SITE MUST HAVE UNDISTURBED SAND, ROCK, SAND AND ROCK UNDER THE CONCRETE DECK.
- 3) THE FOLLOWING IS DETERMINED BY THE ACTUAL ANALYSIS. NO CONDITIONS IN THIS AREA HAVE BEEN BY PAST EXPERIENCE. THE CONTRACTOR SHALL BE RESPONSIBLE FOR THE VERIFICATION OF ALL CONDITIONS OF SUPPORTING A POOL AND LOGIC OF EXISTING SIZE AND LOCATION. THE CONTRACTOR SHALL BE NOTIFIED PRIOR TO ANY CHANGES TO THIS PROJECT.
- 4) ALL CONCRETE SHALL CONFORM TO ACI 318-14. CONCRETE SHALL BE PLACED AND FINISHED IN ACCORDANCE WITH THE CONCRETE MANUAL FOR PLUMBING (PARTICULARLY CHAPTER 10).
- 5) REBAR SHALL BE #4 EPOXY COATED BARS WITH 6" MIN. CLEARANCE FROM ALL SURFACES. ALL REBAR SHALL BE WELDED TOGETHER TO FORM A CONTINUOUS GRID. ALL LAPS AND PLACEMENT SHALL CONFORM TO ACI 318-14.
- 6) FINISH ALL POOL FINISH SHALL BE 1/4" MIN. 1/2" MIN. FINISH OF APPROX. 1/4" APPROX. AND SHALL BE SCHEDULE 40 P.V.C. MIN. POOL FINISH TO COMPLY WITH F.L.C. POOL EQUIPMENT TO APPLY TO F.L.C. APPROVAL.
- 7) WATER SUPPLY AND DRAINAGE SHALL BE SO ARRANGED THAT THERE IS NO BACKFLOW OF WATER INTO THE POOL FROM THE SUPPLY OR DRAINAGE SYSTEMS AND SHALL MEET ALL REQUIREMENTS IN F.L.C.
- 8) EQUIPMENTAL BONDING GRID SHALL BE INSTALLED PER 2017 NEC SECTION 680.2(B)(3)

Digitally signed by
 Bradley M. Akers
 Date: 2023.03.30 11:43:09 -04'00'



B. M. AKERS
 P.E. 66448

POOL PIPING PLAN

TITLE	POOL PIPING PLAN
DESCRIPTION	ADAY RESIDENCE 2629 MOUND AVENUE PANAMA CITY, FL. 32405
DATE	3/30/2023
PAGE	3 OF 4

44'±
 43'± TO 1/4" PROPERTY LINE

PIPING NOTES
 ALL PIPING TO BE PVC SCHEDULE 40 MINIMUM AND ALL PRESSURE PIPING MUST BE PRESSURE TESTED PRIOR TO QUOTE (CONCRETE PROVIDE 3" PIPE DIAMETER CLEAR LENGTH BEFORE PUMPS ON SUCTION SIDE)
 PIPING TO BE INSTALLED 1" MIN BELOW GRADE AND TRENCHES TO BE BACKFILLED W/ CLEAN SAND
 WELL WATER: IF POOL IS TO BE FILLED WITH WELL WATER PROVIDE PREFILTER WHEN FILLING POOL

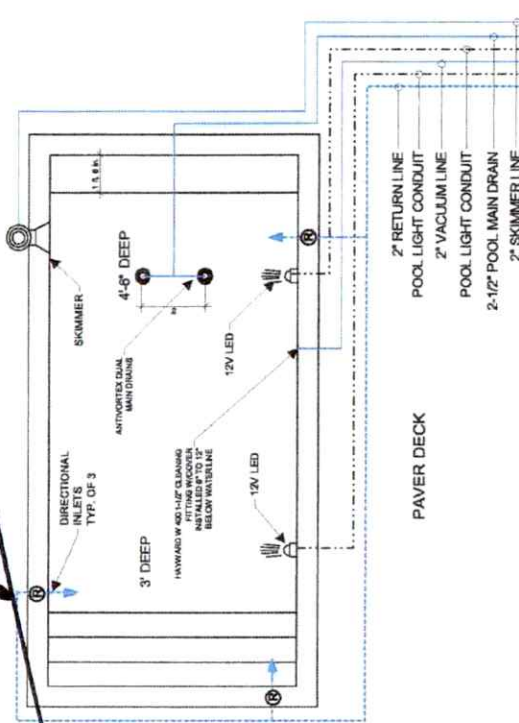

- 2" RETURN LINE
- POOL LIGHT CONDUIT
- 2" VACUUM LINE
- POOL LIGHT CONDUIT
- 2-1/2" POOL MAIN DRAIN
- 2" SKIMMER LINE

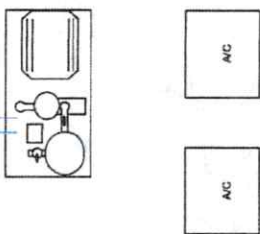

E P Consultants, Inc.
 Plans Examiner
 Michael D Hodges
 State of Florida License # PX384
 Date: 3/30/2023



POOLDESIGN.NET
 30 S.W. 5th COURT
 POMPANO BEACH FLA 33060
 (954) 941-1124
 info@pooldesign.com

CERTIFICATE OF AUTHORIZATION N. 9871

DESIGN PER FLORIDA BUILDING CODE 609.2
 INCLUDING BUT NOT LIMITED TO:
 609.2(1)10.1 ENTRAPMENT PROTECTION FOR SUCTION
 DEVICES
 609.2(1)10.1.1 EQUIPMENT REQUIREMENTS

REVISIONS

- 1) PLANS DRAWING PER CODE, 7th EDITION F.B.C. RESIDENTIAL, AMENDMENT 18, JANUARY 1, 2017.
- 2) THE SITE MUST HAVE UNDERLINED SAND, ROCK, SAND AND ROCK WITH A MINIMUM BEARING VALUE OF 2000 PSF.
- 3) THE FOLLOWING IS DETERMINED BY RATIONAL ANALYSIS. SOIL CONDITIONS IN THIS AREA HAVE BEEN BY PAST EXPERIENCE TO BE ADEQUATE TO SUPPORT THE FOUNDATION OF THIS POOL AND DEPTH OF FOUNDATION SHALL BE NOTIFIED PRIOR TO FUTURE CONSTRUCTION OF THIS PROJECT.
- 4) ALL FOUNDATION DEVICES SHALL BE CONCRETE OR PRECAST CONCRETE WITH REINFORCEMENT FOR PRECAST/CAST-IN-PLACE CONCRETE (QUANTIFICATIONS ARE NOT SHOWN).
- 5) REINFORCEMENT SHALL BE ASTM DESIGNATION #618 GR#6 WITH A MINIMUM YIELD STRENGTH OF 60,000 PSI.
- 6) ALL STEEL SHALL BE A304L OR 316L, UNLESS OTHERWISE SPECIFIED. ALL STEEL SHALL BE GALVANNEAL.
- 7) WATER SUPPLY AND DRAINAGE SHALL BE AS INDICATED. SUPPLY OR WATER DRAINAGE SHALL BE A DOMESTIC WATER SUPPLY.
- 8) THE EQUIPMENT BONDING GRID SHALL BE INSTALLED PER 2017

Digitally signed by
 Bradley M. Akers
 Date: 2023.03.30
 11:43:25
 -04'00'

B. M. AKERS
 P.E. 96449

DETAILS

TITLE	ADAY RESIDENCE
DESCRIPTION	2629 MOUND AVENUE PANAMA CITY, FL 32406
DATE	3/30/2023
PAGE	4 OF 4

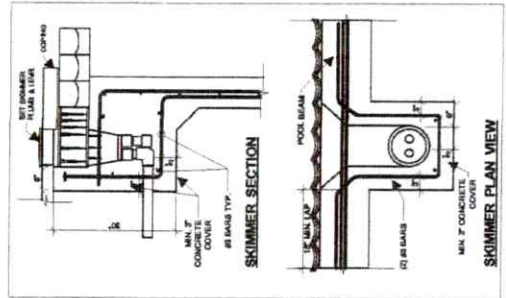
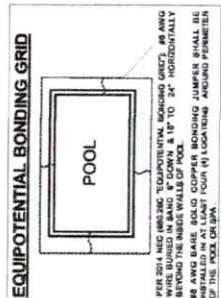

ITEM	TYPE	SIZE	FLOW (GPM)	SPR. HEIGHT	FLOW (GPM)
MAIN DRAIN LINE POOL		3" x 1/2"	30	8.5'	30
RETURN LINE		3"	80	8.5'	80
ANSI/NSF-61					
MAIN DRAIN LINE POOL	3" x 1/2"	30	8.5'	30	30
RETURN LINE	3"	80	8.5'	80	80
PUMP					
CURVE A @3450			26.7		26.7
GALLONS			26.7		26.7
TURN OVER			6.000		6.000
FILTER RATE MAX.			3.75		3.75

POOL SPECIFICATIONS

LENGTH	21' 4" IN.
WIDTH	10' 0" IN.
MIN. DEPTH	3' 0" IN.
MAX. DEPTH	4' 6" IN.
PERIMETER	213' 1"
GALLONS	68,100
INLETS	(3) WALL 1-1/2" DIRECTIONAL INLETS
OUTLETS	(2) LED 12V - PENTAIR
PUMP	(1) PENTAIR INTELLIFLO 11 VARIABLE SPEED
FILTER	CARTRIDGE C200 - PENTAIR
HEATER	ELECTRIC HEAT PUMP

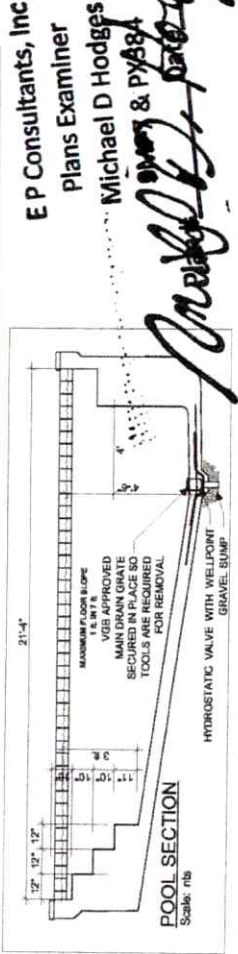
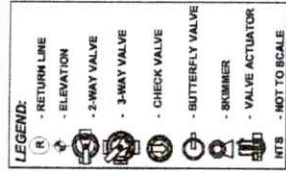
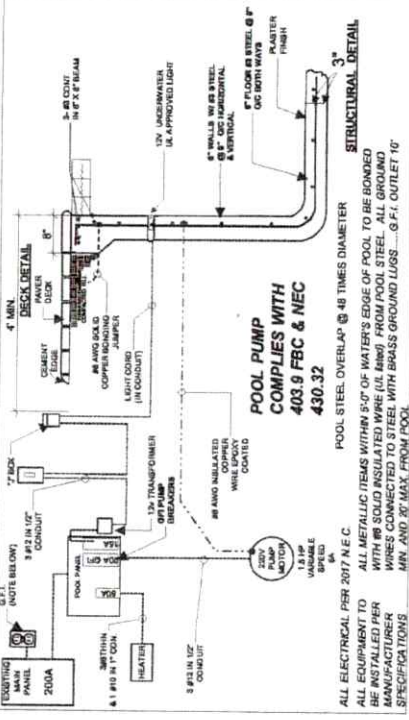
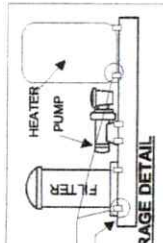
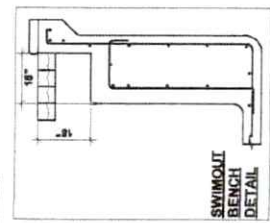
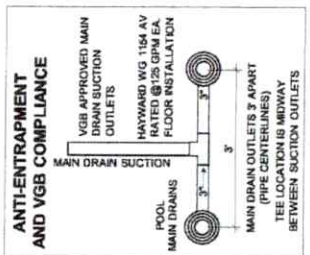

E P Consultants, Inc
 Plans Examiner
 Michael D Hodges
 & P 884

(Handwritten signature)